



Diemaster

METRIC

END MILL DDM Type

Weldon Shank

Fig. 1

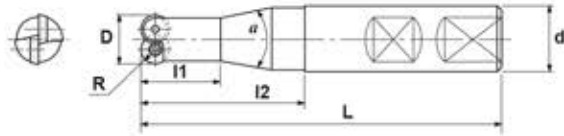

Straight Shank

Fig. 2

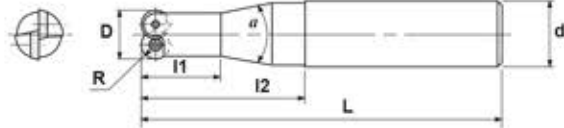

Small Shank

Fig. 3

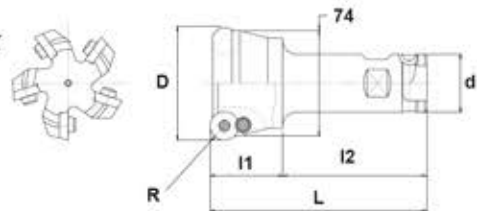

Specifications

CATALOG NUMBER	STK	DIMENSIONS								INSERT	Q	PARTS		
		D	R	L	I1	I2	a	d	FIG.			Screw	Wrench	Other
DDM-2120-40-W16	•	12	3.5	88	20	40	23°	16	1	RDHX0701MO*	2	CSW-2542	A-07	-
DDM-2120-60-W16	•	12	3.5	108	20	60	9°	16	1					
DDM-2120-80-W20	•	12	3.5	130	20	80	10°	20	1					
DDM-2150-80-S20	■	15	3.5	130	20	80	7°10'	20	2	RDHX0702MO*	2	CSW-2547	A-07	-
DDM-2160-40-W16	•	16	3.5	88	20	40	-	16	1	RDHX0702MO*	2	CSW-2547	A-07	-
DDM-2160-60-W16	•	16	3.5	108	20	60	2°41'	16	1					
DDM-2160-80-W20	•	16	3.5	130	20	80	6°03'	20	1					
DDM-2160-100-W20	•	16	3.5	150	20	100	4°22'	20	1					
DDM-2200-40-W20	•	20	5	90	23	40	-	20	1	RDHX1003MO*	2	CSW-3570	A-15	-
DDM-2200-60-W20	•	20	5	110	23	60	3°10'	20	1					
DDM-2200-80-W25	•	20	5	136	23	80	8°	25	1					
DDM-2200-100-W25	•	20	5	156	23	100	5°30'	25	1					
DDM-2200-120-W25	•	20	5	176	23	120	4°20'	25	1					
DDM-2250-70-W25	•	25	6	126	23	70	3°40'	25	1	RDHX12T3MO*	2	CSW-3595	A-15	CB3540
DDM-2250-80-W25	•	25	6	136	23	80	2°55'	25	1					
DDM-2250-124-W25	•	25	6	180	-	124	-	25	1					
DDM-2320-80-W32	•	32	6	140	30	80	3°	32	1	RDHX12T3MO*	2	CSW-3595	A-15	CB3540
DDM-2320-140-W32	•	32	6	200	-	140	-	32	1					
DDM-5080-50-S200		80	10	152	51	101.6	-	50.8	3	RDHX2006MO*	2	CSW-4510	A-20	CW-11

Note: All cutters are supplied without inserts.



METRIC

Diemaster

FACE MILL
DDM Type



Entering Angle	A.R. : 0°
	★ A.R. : 8°
	R.R. : 0°
Max. D.O.C.	12mm insert: 4mm
	16mm insert: 5mm

Fig. 1

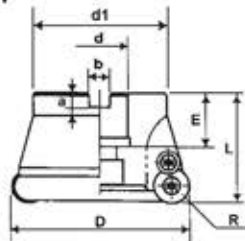
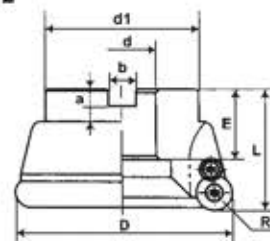

Fig. 2



Specifications

CATALOG NUMBER	STK	DIMENSIONS									INSERT	Q	PARTS		
		D	R	L	d	d1	a	b	E	FIG.			Screw	Wrench	Other
DDM-3040-16R-12	•	40	6	45	16	35	5.6	8.4	18	1	RDHX12T3MO* RDMX12T3MOT	3	CSW-3595	A-15T	CB3540
DDM-5050-12	■	50	6	45	22	45	6.3	10.4	20	2	RDHX12T3MO* RDMX12T3MOT	5	CSW-3595	A-15T	CB3540
DDM-4050-16	■	50	8	45	22	45	6.3	10.4	20	2	RDHX1604MO* RDMX1604MOT RDMT1604MOT	4	CSW-4510	A-20	CW-11
DDM-5052-22R-12	•	52	6	50	22	45	6.3	10.4	20	2	RDHX12T3MO* RDMX12T3MOT	5	CSW-3595	A-15T	CB3540
DDM-5052-22R-12-AR8★	■	52	6	50	22	45	6.3	10.4	20	2	RDHX12T3MO* RDMX12T3MOT	5	CSW-3595	A-15T	CB3540
DDM-4052-22R-16	•	52	8	45	22	50	6.3	10.4	20	2	RDHX1604MO* RDMX1604MOT RDMT1604MOT	4	CSW-4510	A-20	CW-11
DDM-3063-27R-12	•	63	6	50	27	50	7	12.4	22	2	RD(M)HX12T3MO*	3	CSW-3595	A-15T	CB3540
DDM-6063-27R-12	•	63	6	50	27	50	7	12.4	20	2	RD(M)HX12T3MO*	6	CSW-3595	A-15T	CB3540
DDM-5063-16	■	63	8	45	22	50	6.3	10.4	20	2	RD(M)HX1604MO*	5	CSW-4510	A-20	CW-11
DDM-5063-27R-16	•	63	8	50	27	50	7	12.4	20	2	RD(M)HX1604MO*	5	CSW-4510	A-20	CW-11

Diemaster

METRIC

FACE MILL DDM Type



Entering Angle	A.R. : 0°
	★★ A.R. : 6°
	R.R. : 0°
Max. D.O.C.	12mm insert: 4mm
	16mm insert: 5mm

Fig. 1

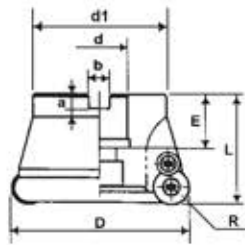
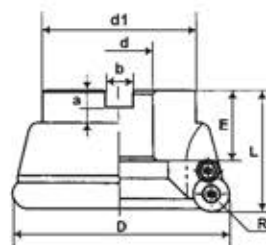

Fig. 2



Specifications

CATALOG NUMBER	STK	DIMENSIONS									INSERT	Q	PARTS		
		D	R	L	d	d1	a	b	E	FIG.			Screw	Wrench	Other
DDM-6066-27R-12	•	66	6	50	27	50	7	12.4	22	2	RD(M)HX12T3MO*	6	CSW-3595	A-15T	CB3540
DDM-5066-27R-16	•	66	8	50	27	50	7	12.4	22	2	RD(M)HX1604MO*	5	CSW-4510	A-20	CW-11
DDM-4080-27R-12	•	80	6	55	27	60	7	12.4	22	3	RD(M)HX12T3MO*	4	CSW-3595	A-15T	CB3540
DDM-7080-27R-12	•	80	6	55	27	60	7	12.4	22	3	RD(M)HX12T3MO*	7	CSW-3595	A-15T	CB3540
DDM-6080-27R-16	•	80	8	55	27	60	7	12.4	22	3	RD(M)HX1604MO*	6	CSW-4510	A-20	CW-11
DDM-5080AR6-20★★		80	10	50.8	25.4	63.5	8	12.7	19	2	RDHX2006MO*	5	CSW-4510	A-20	CW-11
DDM-7100-32R-16	•	100	8	55	32	70	8	14.4	32	3	RD(M)HX1604MO*	7	CSW-4510	A-20	CW-11
DDM-6100-20		100	10	55	31.75	70	8	12.7	32	3	RDHX2006MO*	6	CSW-4510	A-20	CW-11
DDM-8125-40R-16	•	125	8	55	40	85	9	16.4	32	3	RD(M)HX1604MO*	8	CSW-4510	A-20	CW-11
DDM-9160-40R-16	•	160	8	55	40	120	9	16.4	32	3	RD(M)HX1604MO*	9	CSW-4510	A-20	CW-11
DDM-8160-20		160	10	55	50.8	120	11	19	37	3	RDHX2006MO*	8	CSW-4510	A-20	CW-11

Note: All cutters are supplied without inserts.



METRIC

Diemaster

MODULAR HEADS

MDH Type



Fig. 1

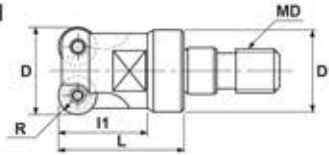

Fig. 2

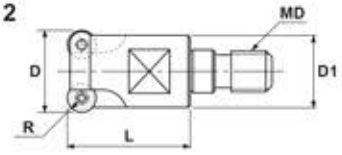
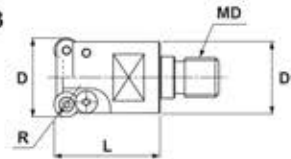

Fig. 3



Specifications

CATALOG NUMBER	STK	DIMENSIONS					FIG.	HEAD TORQUE Nm	INSERT	Q	PARTS		
		D	R	L	D1	MD					Screw	Wrench	Other
MDH-2120-M8	•	12	3.5	23	15	M8	1	16	RDHX0701MO*	2	CSW-2542	A-07	-
MDH-2160-M8	•	16	3.6	23	15	M8	1	16	RDHX0702MO*	2	CSW-2547	A-07	-
MDH-2200-M10	•	20	5	30	19	M10	1	16	RDHX1003MO*	2	CSW-3570	A-15	-
MDH-2250-M12	•	25	5	35	21	M12	2	20	RDHX1003MO*	2	CSW-3570	A-15	-
MDH-3320-R10-M16	•	32	5	43	29	M16	3	25	RDHX1003MO*	3	CSW-3575	A-15	CB3540
MDH-2320-R16-M16	•	32	8	43	29	M16	2	25	RDHX1604MO*	2	CSW-4510	A-20	-
MDH-4400-M16	•	40	6	42	29	M16	3	25	RDHX12TMO*	4	CSW-3595	A-15	CB3540

Note: All cutters are supplied without inserts.

Modular Heads for High Speed Cutting

Specifications

CATALOG NUMBER	STK	DIMENSIONS					FIG.	HEAD TORQUE Nm	INSERT	Q	PARTS		
		D	R	L	D1	MD					Screw	Wrench	Other
MDH-3160-M8	•	16	3.5	23	15	M8	1	16	RDHX0701MOT	3	CSW-2542	A-07	-
MDH-4160-M8	•	16	2.5	23	13.7	M8	2	16	RDHX0501MOT	4	CSW-1838	A-06	-
MDH-4200-M10	•	20	3.5	30	17.6	M10	2	16	RDHX0702MOT	4	CSW-2547	A-07	-
MDH-5200-M10	•	20	2.5	30	17.8	M10	2	16	RDHX0501MOT	5	CSW-1838	A-06	-
MDH-5250-M12	•	25	3.5	35	20.8	M12	2	20	RDHX0702MOT	5	CSW-2547	A-07	-
MDH-6350-M16	•	35	3.5	43	29	M16	2	25	RDHX0702MOT	6	CSW-2547	A-07	-

Note: All cutters are supplied without inserts.

Diemaster

METRIC

INSERTS



Fig. 1

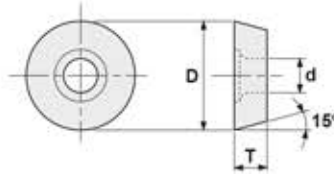
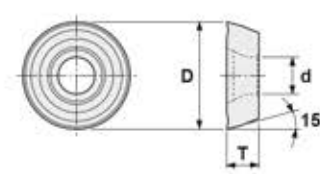

Fig. 2



Specifications

CATALOG NUMBER	IC TOLERANCE	DIMENSIONS			FIG.	COATED GRADES				UNCOATED GRADES	
		D	T	d		JC8003	JC8015	JC5030	JC5040	CX90	KT9
RDHX0501MOT	H	5	1.5	2.0	1	•	•				
RDHX0701MOT	H	7	1.99	2.8	1	•	•	•	•	•	
RDHX0702MOT	H	7	2.38	2.8	1	•	•	•	•	•	
RDHX1003MOT	H	10	3.18	3.9	1	•	•	•	•	•	
RDHX12T3MOF	H	12	3.97	3.9	1						•
RDHX12T3MOT	H	12	3.97	3.9	1	•	•	•	•	•	
RDMX12T3MOT	M	12	3.97	3.9	1			•	•		
RDHX1604MOT	H	16	4.76	5.0	1	•	•	•	•	•	
RDMX1604MOT	M	16	4.76	5.0	1		•	•	•		
RDMT1604MOT	M	16	4.76	5.5	2				•		
RDHX2006MOT	H	20	6.0	6.0	1			•			

INSERTS FOR ALUMINUM

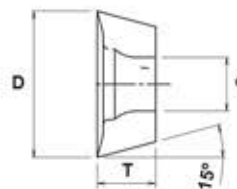
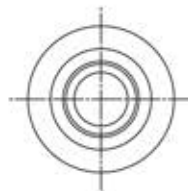

Specifications

CATALOG NUMBER	IC TOLERANCE	DIMENSIONS			COATED GRADES				UNCOATED GRADES	
		D	T	d	JC8003	JC8015	JC5030	JC5040	CX90	KT9
RDHT0501MOF	H	5	1.5	2						•
RDHT0701MOF	H	7	1.99	2.8						•
RDHT0702MOF	H	7	2.38	2.8						•
RDHT1003MOF	H	10	3.18	3.9						•
RDHT12T3MOF	H	12	3.97	3.9						•
RDHT1604MOF	H	16	4.76	5						•