

Hepta Mill

HEP_{TYPE}

G-Body

Through Coolant Hole (except dia. $\phi 200$)

Fig. 1

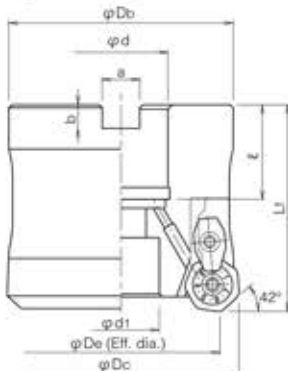

Fig. 2 (Without coolant hole)

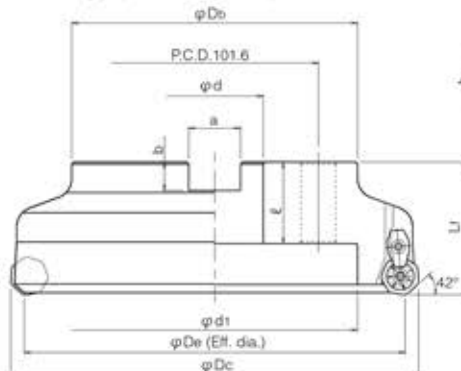
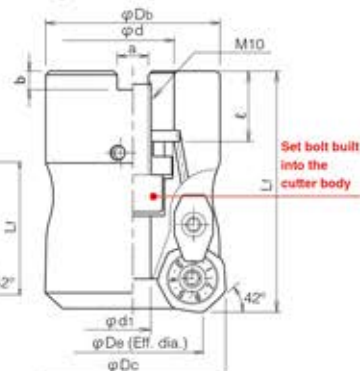

Fig. 3



BODY/FACE MILL TYPE

Type	Cat. No.	Stock	No. of flutes	Dimensions (mm)									Head cap screw (JIS Standard)	weight (kg)	Fig.
				ϕD_c	ϕD_e (Eff. dia.)	Lf	ϕD_b	ϕd	ϕd_1	a	b	ℓ			
Metric Bore	HEP-3050R-08-22	●	3	50	36.7	65	47	22	9.6	10.4	6.3	19	※M10×1.5×25	0.9	3
	HEP-4063R-08-22	●	4	63	49.5	50	60	22	17	10.4	6.3	20	M10	1.1	1
	HEP-4063R-08-27	●	4	63	49.5	50	60	27	20	12.4	7	22	※M12×1.75×30	1.1	1
	HEP-5080R-08-27	●	5	80	66.6	55	76	27	20	12.4	7	22	※M12×1.75×40	1.9	1
	HEP-6100R-08-32	●	6	100	86.6	70	96	32	26	14.4	8	32	※M16×2.0×45	3.6	1
	HEP-7125R-08-40	●	7	125	111.6	70	100	40	32	16.4	9	35	※M20×2.5×45	5.5	1
	HEP-8160R-08-40	●	8	160	146.6	70	100	40	32	16.4	9	35	※M20×2.5×45	8.4	1
	HEP-9200R-08-60	●	9	200	186.6	65	140	60	140	25.4	14.3	40	M16	10.2	2

- Note) 1. All cutters are supplied without inserts.
 2. Please refer page C112-C119 for recommended cutting conditions.
 3. ※ Mark shows: these cutter bodies are equipped with the set bolt because of the specified bolt size. Except for these cutter bodies, please use the set bolt equipped with arbor.
 4. In case of using double clamping mechanism type, please refer page C009.

Hepta Mill

HEP_{TYPE}

■ INSERTS

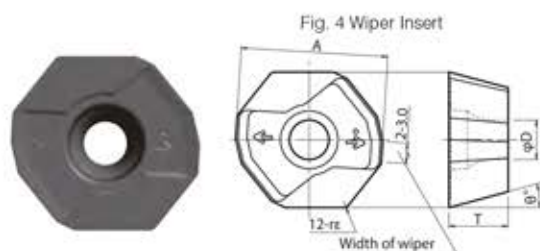
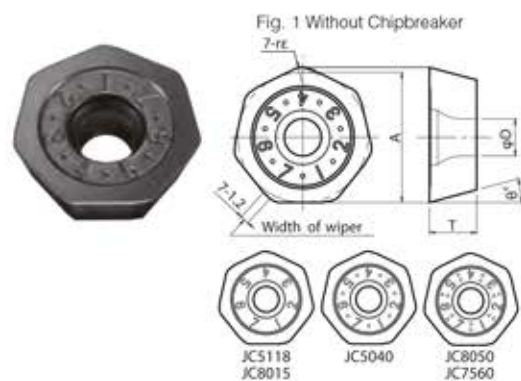

Cat. No.	Tolerance	Dimensions (mm)					PVD coated						Fig.
		A	T	φD	rε	θ°	JC8015	JC5040	JC5118	JC8118	JC8050	JC7560	
XDMW080620ZTR	M	17.5	6.35	5	2	15	●	○	○		●	●	1
XDMW080635ZTR-S	M	17.5	6.35	5	3.5	15	●						2
XDMT080620ZER	M	17.5	6.35	5	2	15	●		○		●	●	3
XDMT080708ZER (Wiper Insert)	M	18.6	7.5	5	0.8	15	●						4
XDMT080620ZER-ML	M	17.3	6.5	5	2	15				●		●	3

10 inserts per case

■ How to use of corner change



Recommend to rotate the insert counter-clockwise for corner change.