

5
axis

KRM
TYPE

Insert for "MIRROR BARREL" KRM type

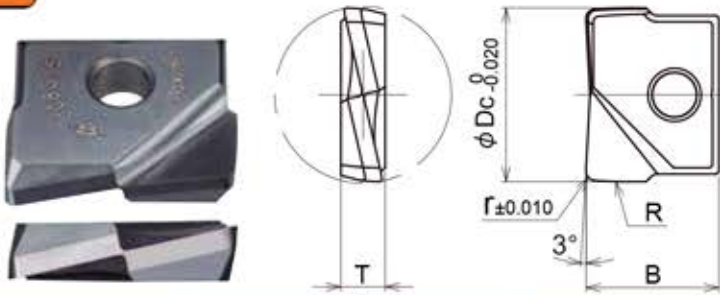

Corner radius accuracy of inserts: within $\pm 0.010\text{mm}$

Radius form accuracy on the outer periphery: within $\pm 0.010\text{mm}$

Cat. No.	PVD coated		(mm) Dimensions				
	JC8015 (Z10-20)	DH102 (Z01)	R	r	ϕDc	B	T
KRM-160-R10-BR50	⊙	⊙	50	1	16	12	4
KRM-200-R10-BR60	⊙	⊙	60	1	20	15	5

Note) Use only MIRROR RADIUS modular head MRX type or carbide shank end mill style.

5
axis

MRX
TYPE

Modular head MRX type

Through coolant hole

Accuracy of MRX after combined O.D. run out: below $15\mu\text{m}$ (Target below $10\mu\text{m}$)

-In case of using KRM type insert / Corner radius accuracy: within $\pm 0.010\text{mm}$, radius form accuracy on the outer periphery: within $\pm 0.010\text{mm}$

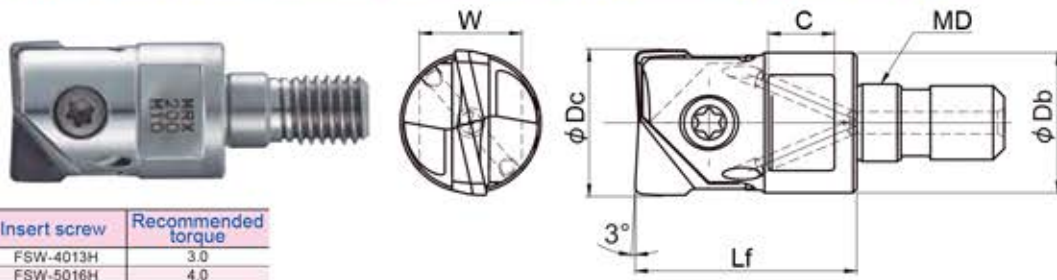

Insert screw	Recommended torque
FSW-4013H	3.0
FSW-5016H	4.0

Cat. No.		Stock	(mm) Dimensions						Applicable inserts	Parts	
			ϕDc	Lf	ϕDb	MD	C	W		Clamp screw	Wrench
NEW	OLD										
MRX-160-M8	MRN-160-M8 (-H)	●	16	23	15	M8	8	12	RNM-160/170-.../HRM-160/170-... FRM-160/170-.../KRM-160-...	FSW-4013H	T-15
MRX-200-M10	MRN-200-M10 (-H)	●	20	30	19	M10	8	14	RNM-200/210-.../HRM-200/220-... FRM-200/210-.../KRM-200-...	FSW-5016H	A-20W

Note) 1. All holders are supplied without inserts & wrench.

2. Please see below for recommended tightening torque on Modular Head. (When mounting head to shank, recommend to use DIJET DS type spanner wrench to prevent over tightening.)

◆ Tightening Torque for head

Thread	Tightening torque for head	Spanner size	Cat No. of spanner wrench DS type
M8	16N·m	12	DS-12
M10	16N·m	14	DS-14
M12	20N·m	17	DS-17
M16	25N·m	22	DS-22