

Side Chipper

METRIC

END MILL STYLE

SIC type



Fig. 1

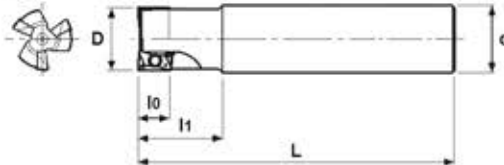
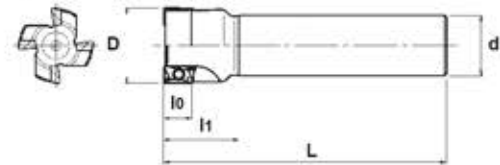

Fig. 2



Specifications

CATALOG NUMBER	STK	DIMENSIONS					FIG.	INSERT	Q	PARTS	
		D	L	l ₀	l ₁	d				Screw	Wrench
SICM1610S16-2N	•	16	100	10	25	16	1	ZCMT1003..R	2	ESW-206	A-08SD
SICL1610S16-2N	•	16	150	10	25	16	1		2		
SICM2010S20-3N	•	20	110	10	25	20	1	ZCMT1003..R	3	ESW-206	A-08SD
SICL2010S20-2N	•	20	180	10	40	20	1		2		
SICL2010S20-3N	•	20	180	10	40	20	1		3		
SICM2510S25-4N	•	25	120	10	32	25	1	ZCMT1003..R	4	ESW-206	A-08SD
SICM2513S25-3N	•	25	120	13	32	25	1	ZPMT13T3..R	3	DSW-307	A-10
SICL2513S25-2N	•	25	210	13	35	25	1		2		
SICL2513S25-3N	•	25	210	13	35	25	1		3		
SICM3016S32-3N	•	30	150	15	40	32	1	ZPMT1604..R	3	TSW-408	A-15
SICL3016S25-3N	•	30	250	15	65	25	2		3		
SICM3210S32-5N	•	32	150	10	40	32	1	ZCMT1003..R	5	ESW-206	A-08SD
SICM3216S32-3N	•	32	150	15	40	32	1	ZPMT1604..R	3	TSW-408	A-15
SICL3216S32-2N	•	32	250	15	65	32	1		2		
SICL3216S32-3N	•	32	250	15	65	32	1		3		
SICM4010S32-6N	•	40	150	10	40	32	2	ZCMT1003..R	6	ESW-206	A-08SD
SICM4016S32-4N	•	40	150	15	40	32	2	ZPMT1604..R	4	TSW-408	A-15
SICL4016S32-4N	•	40	250	15	65	32	2		4		
SICM5010S32-7N	•	50	150	10	40	32	2	ZCMT1003..R	7	ESW-206	A-08SD
SICM5016S32-5N	•	50	150	15	40	32	2	ZPMT1604..R	5	TSW-408	A-15
SICL5015S42-5N	•	50	250	15	65	42	2		5		

Note: All cutters are supplied without inserts.



METRIC

Side Chipper

FACE MILLS
SIC type



Entering Angle : 90°	A.R. : +4°
	R.R. : -1° - 4°
Max. D.O.C.	15

Fig. 1

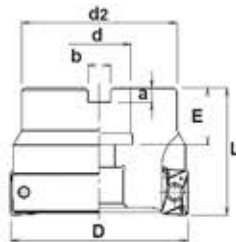
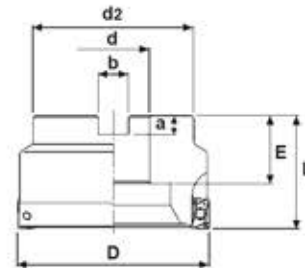

Fig. 2



Specifications

CATALOG NUMBER	STK	DIMENSIONS							FIG.	INSERT	Q	PARTS	
		D	L	d	d2	a	b	E				Screw	Wrench
SIC-4050R	■	50	45	22.225	45	5	8	20	1	ZPMT1604..R	4	TSW-408	A-15T
SIC-4050R-22	•	50	45	22	45	6.3	10.4	20	1		4		
SIC-5063R	■	63	45	22.225	45	5	8	20	1		5		
SIC-5063R-22	•	63	45	22	55	3.3	10.4	20	1		5		
SIC-6080R	■	80	44	25.4	60	6	9.5	24	1		6		
SIC-6080R-27	•	80	50	27	60	7	12.4	22	2		6		
SIC-8100R	■	100	50	31.75	70	8	12.7	32	2		8		
SIC-8100R-32	•	100	50	32	70	8	14.4	32	2		8		
SIC-8125R	■	125	63	38.1	85	10	15.9	36	2		8		
SIC-8125R-40	•	125	63	40	85	9	16.4	35	2		8		

Note: All cutters are supplied without inserts.

Side Chipper

METRIC

MODULAR HEADS

MIC type

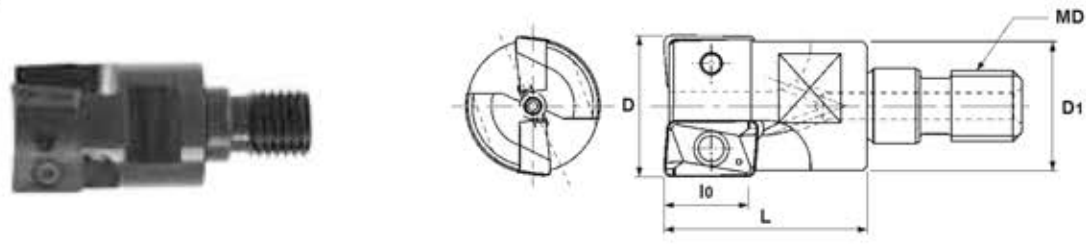

Specifications

CATALOG NUMBER	STK	DIMENSIONS					HEAD TORQUE Nm	INSERT	Q	PARTS	
		D	L	l ₀	D ₁	MD				Screw	Wrench
MIC-2016-M8	•	16	23	9	14.6	M8	16	ZCMT1003..R	2	ESW-206	A-08SD
MIC-2018-M8	•	18	23	9	15.5	M8	16	ZCMT1003..R	2	ESW-206	A-08SD
MIC-2020-M10	•	20	30	9	18.4	M10	16	ZCMT1003..R	2	ESW-206	A-08SD
MIC-3020-M10	•	20	30	9	18.4	M10	16	ZCMT1003..R	3	ESW-206	A-08SD
MIC-2022-M10	•	22	30	12.5	19.5	M10	16	ZPMT13T3..R	2	DSW-307H	A-10
MIC-3022-M10	•	22	30	9	19.5	M10	16	ZCMT1003..R	3	ESW-206	A-08SD
MIC-2025-M12	•	25	35	15	23	M12	20	ZPMT1604..R	2	TSW-408	A-15
MIC-3025-M12	•	25	35	12.5	23	M12	20	ZPMT13T3..R	3	DSW-307H	A-10SD
MIC-2027-M12	•	27	35	15	24	M12	20	ZPMT1604..R	2	TSW-408	A-15
MIC-3027-M12	•	27	35	12.5	24	M12	20	ZPMT13T3..R	3	DSW-307H	A-10
MIC-3030-M16	•	30	43	15	28.2	M16	25	ZPMT1604..R	3	TSW-408	A-15
MIC-2032-M16	•	32	43	15	29	M16	25	ZPMT1604..R	2	TSW-408	A-15
MIC-3032-M16	•	32	43	15	29	M16	25	ZPMT1604..R	3	TSW-408	A-15
MIC-2035-M16	•	35	43	15	29	M16	25	ZPMT1604..R	2	TSW-408	A-15
MIC-4040-M16	•	40	43	15	29	M16	25	ZPMT1604..R	4	TSW-408	A-15
MIC-5040-M16	•	40	43	12.5	29	M16	25	ZPMT13T3..R	5	DSW-307H	A-10

Note: All cutters are supplied without inserts.

**METRIC**

Side Chipper

INSERTS

Inserts

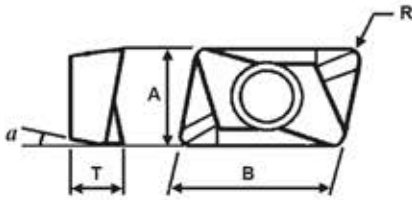
 	CATALOG NUMBER	DIMENSIONS					STOCK	
		A	B	T	R	α	COATED	
							JC5015	JC5040
ZCMT100304R	6.35	10.4	3.4	0.4	7°	•	•	
ZCMT100308R	6.35	10.4	3.4	0.8	7°	•	•	
ZPMT13T308R	7.938	13.3	3.97	0.8	11°	•	•	
ZPMT13T316R	7.938	13.3	3.97	1.6	11°	•	•	
ZPMT13T320R	7.938	13.3	3.97	2.0	11°	•	•	
ZPMT160404R	9.525	16	4.76	0.4	11°	•	•	
ZPMT160408R	9.525	16	4.76	0.8	11°	•	•	
ZPMT160416R	9.525	16	4.76	1.6	11°	•	•	
ZPMT160420R	9.525	16	4.76	2.0	11°	•	•	
**ZPMT160430R	9.525	16	4.76	3.0	11°	•	•	
**ZPMT160432R	9.525	16	4.76	3.2	11°	•	•	

** Note: Body must be modified to 1.5 radius or 1.2 chamfer at corner to use these inserts.

Polished Inserts For Aluminum

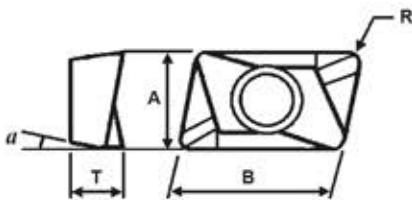
 	CATALOG NUMBER	DIMENSIONS					STOCK	
		A	B	T	R	α	UNCOATED	
							FZ15	
ZCMT100308RP	6.35	10.4	3.4	0.8	7°	•		
ZPMT13T308RP	7.938	13.3	3.97	0.8	11°	•		
ZPMT13T316RP	7.938	13.3	3.97	1.6	11°	•		
ZPMT13T320RP	7.938	13.3	3.97	2.0	11°	•		
ZPMT160408RP	9.525	16	4.76	0.8	11°	•		
ZPMT160416RP	9.525	16	4.76	1.6	11°	•		
ZPMT160420RP	9.525	16	4.76	2.0	11°	•		
**ZPMT160430RP	9.525	16	4.76	3.0	11°	•		
**ZPMT160432RP	9.525	16	4.76	3.2	11°	•		

** Note: Body must be modified to 1.5 radius or 1.2 chamfer at corner to use these inserts.