

Line up

● Facemill type (standard type)

- Through coolant hole
- Double clamp

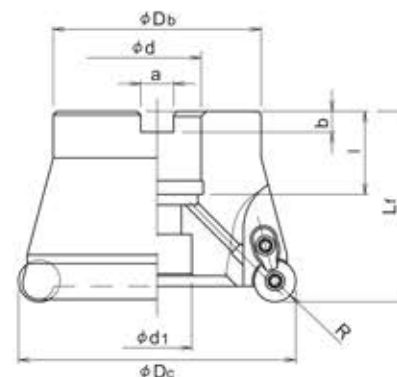

Type	Cat. No.	Stock	No. of inserts	Dimensions (mm)									Inserts	Parts		
				ϕD_c	R	L_f	ϕD_b	ϕd	ϕd_1	a	b	l		Clamp screw	Clamp set	Wrench
Metric Bore	HDM-3050-12R-22	●	3	50	6	50	47	22	16.5	10.4	6.3	20	RD**1204M0*	DSW-4085	DCM-18	A-15T
	HDM-3050-16R-22	●	3	50	8	55	47	22	16.5	10.4	6.3	20	RD**1606M0*	DSW-4512H	DCM-17	A-20
	HDM-4063-12R-22	●	4	63	6	50	60	22	16.5	10.4	6.3	20	RD**1204M0*	DSW-4085	DCM-18	A-15T
	HDM-4063-16R-22	●	4	63	8	50	60	22	16.5	10.4	6.3	20	RD**1606M0*	DSW-4512H	DCM-17	A-20

● Standard stock items









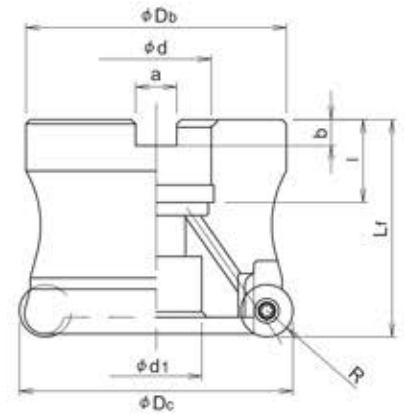















Note) 1.All cutters are supplied without inserts.

2 Please see page 13-14 for cutting conditions.

● Facemill type (fine pitch)

- Through coolant hole



Type	Cat. No.	Stock	No. of inserts	Dimensions (mm)									Inserts	Parts	
				ϕD_c	R	L_f	ϕD_b	ϕd	ϕd_1	a	b	l		Clamp screw	Wrench
Metric Bore	HDM-4050-16R-22	●	4	50	8	55	47	22	16.5	10.4	6.3	20			
	HDM-5050-12R-22	●	5	50	6	50	47	22	16.5	10.4	6.3	20			
	HDM-4052-16R-22	●	4	52	8	55	47	22	16.5	10.4	6.3	20			
	HDM-5052-12R-22	●	5	52	6	50	47	22	16.5	10.4	6.3	20			
	HDM-5063-16R-27	●	5	63	8	50	60	27	20	12.4	7	22			
	HDM-6063-12R-27	●	6	63	6	50	60	27	20	12.4	7	22			
	HDM-5066-16R-27	●	5	66	8	50	60	27	20	12.4	7	22			
	HDM-6066-12R-27	●	6	66	6	50	60	27	20	12.4	7	22			
	HDM-6080-16R-27	⊙	6	80	8	55	76	27	20	12.4	7	22			
	HDM-7080-12R-27	⊙	7	80	6	55	76	27	20	12.4	7	22			

● Standard stock items; ⊙ Soon to be stocked

Note) 1. All cutters are supplied without inserts.

2. Please see page 13-14 for cutting conditions.

SDH heads type (standard type)

● Through coolant hole

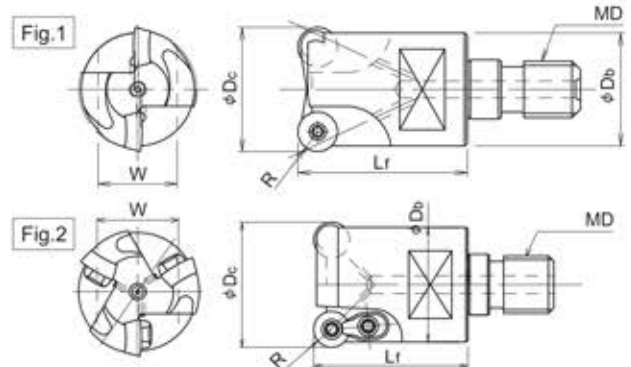

Cat. No.	Stock	No. of inserts	Dimensions (mm)						Inserts	Parts			Fig.
			φDc	R	Lr	φDb	MD	W		Clamp screw	Clamp set	Wrench	
SDH-2200-R07-M10 ^{※1}	●	2	20	3.5	30	18	M10	14	RD**07T2M0*	TSW-2556H	—	A-08SD	1
SDH-2220-R07-M10 ^{※3}	●	2	22	3.5	30	20	M10	14	RD**07T2M0*	TSW-2556H	—	A-08SD	1
SDH-2250-R10-M12	●	2	25	5	35	23	M12	17	RD**1004M0*	CSW-408H	DCM-18	A-15	2
SDH-2280-R10-M12	●	2	28	5	35	25	M12	17	RD**1004M0*	CSW-408H	DCM-18	A-15	2
SDH-2300-R10-M16	●	2	30	5	43	28	M16	22	RD**1004M0*	CSW-408H	DCM-18	A-15	2
SDH-2320-R12-M16	●	2	32	6	43	28	M16	22	RD**1204M0*	DSW-4085	DCM-18	A-15	2
SDH-3320-R10-M16	●	3	32	5	43	28	M16	22	RD**1004M0*	CSW-408H	DCM-18	A-15	2
SDH-2350-R12-M16	●	2	35	6	43	32	M16	22	RD**1204M0*	DSW-4085	DCM-18	A-15	2
SDH-3350-R10-M16	●	3	35	5	43	32	M16	22	RD**1004M0*	CSW-408H	DCM-18	A-15	2
SDH-2400-R12-M16	●	2	40	6	43	32	M16	26	RD**1204M0*	DSW-4085	DCM-18	A-15	2

● Standard stock items

Note) 1. All cutters are supplied without inserts.

2. Please see page 17-19 for cutting conditions.

3. In case of machining perpendicular wall, shank clearance of combination ※1 is small, so we recommend to use ※3 heads.

SDH heads type (fine pitch type)

● Through coolant hole

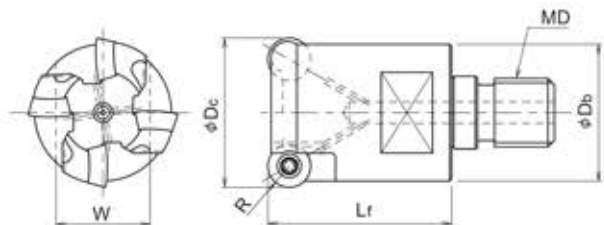

Cat. No.	Stock	No. of inserts	Dimensions (mm)						Inserts	Parts	
			φDc	R	Lr	φDb	MD	W		Clamp screw	Wrench
SDH-3200-R07-M10 ^{※1}	●	3	20	3.5	30	18	M10	14	RD**07T2M0*	TSW-2556H	A-08SD
SDH-3220-R07-M10 ^{※3}	●	3	22	3.5	30	20	M10	14	RD**07T2M0*	TSW-2556H	A-08SD
SDH-3250-R07-M12	●	3	25	3.5	35	23	M12	17	RD**07T2M0*	TSW-2556H	A-08SD
SDH-3250-R10-M12	●	3	25	5	35	23	M12	17	RD**1004M0*	CSW-408H	A-15
SDH-3280-R10-M12	●	3	28	5	35	25	M12	17	RD**1004M0*	CSW-408H	A-15
SDH-3300-R10-M16	●	3	30	5	43	28	M16	22	RD**1004M0*	CSW-408H	A-15
SDH-4300-R10-M16	●	4	30	5	43	28	M16	22	RD**1004M0*	CSW-408H	A-15
SDH-4320-R10-M16	●	4	32	5	43	28	M16	22	RD**1004M0*	CSW-408H	A-15
SDH-3350-R12-M16	●	3	35	6	43	32	M16	22	RD**1204M0*	DSW-4085	A-15
SDH-4350-R10-M16	●	4	35	5	43	32	M16	22	RD**1004M0*	CSW-408H	A-15
SDH-4400-R12-M16	●	4	40	6	43	32	M16	26	RD**1204M0*	DSW-4085	A-15
SDH-5420-R10-M16	●	5	42	5	43	32	M16	26	RD**1004M0*	CSW-408H	A-15

● Standard stock items

Note) 1. All cutters are supplied without inserts.

2. Please see page 17-19 for cutting conditions.

3. In case of machining perpendicular wall, shank clearance of combination ※1 is small, so we recommend to use ※3 heads.

Inserts without chipbreaker

■ RDMW-MOT

Without chip breaker

For Steel

Chamfer Honing

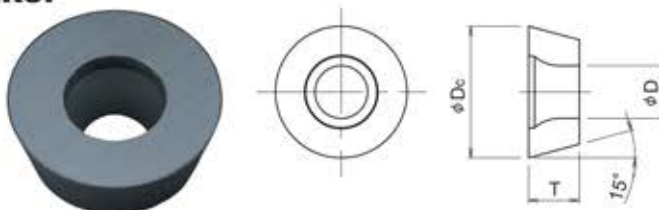

Cat. No.	Coated			Dimensions (mm)		
	JC8003	JC8015	JC5040	ϕD_c	T	ϕD
RDMW07T2MOT	●	●	●	7	2.7	2.8
RDMW1004MOT	●	●	●	10	4.1	4.4
RDMW1204MOT	●	●	●	12	4.8	4.4
RDMW1606MOT	●	●	●	16	6	5

● Standard stock items

Inserts with chipbreaker

■ RDGT-MOT

With chip breaker

Chamfer Honing

For Stainless Steel & Steel

■ RDGT-MOE

With chip breaker

R Honing

For Titanium & Inconel

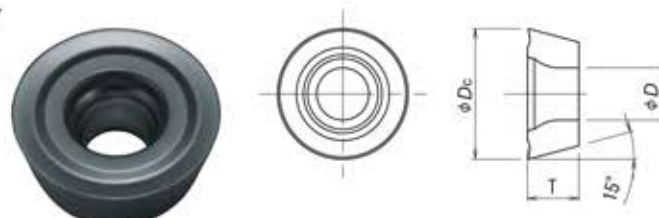

Cat. No.	Coated		Dimensions (mm)		
	JC8015	JC8050	ϕD_c	T	ϕD
RDGT07T2MOE	●	●	7	2.7	2.8
RDGT1004MOE	●	●	10	4.1	4.4
RDGT1004MOT	●	●	10	4.1	4.4
RDGT1204MOE	●	●	12	4.8	4.4
RDGT1204MOT	●	●	12	4.8	4.4
RDGT1606MOE	●	●	16	6	5
RDGT1606MOT	●	●	16	6	5

● Standard stock items

Recommended tightening torque for modular head

Thread	Tightening Torque	Wrench size
M10	46 N·m	14, 15
M12	80 N·m	17
M16	90 N·m	22, 26

★ Attention to mounting head

Clean the contact surface of head and carbide holder, and also confirm there is no gap between head and holder after tightening.